



# GARDENS PARK



LIVE THE LIFE YOU DESERVE



BAHÇELER / İSKELE

TYPE

AC LOFT 1

2 + 1 • FIRST FLOOR

ÖZELLİKLER / SPECIFICATIONS

- |   |   |
|---|---|
| 2 Yatak Odası   | • 2 Bedrooms                                    |
| 25 Daireden Oluşan Site İçerisinde Ortak Kullanım Havuz | • In the Site Consisting of 25 Apartments       |
| Loft Daire  | • Common Pool                                   |
| Özel Berbekeküli Geniş Çatı Terası                      | • Loft Apartment                                |
| Özel Araç Çatı Alanı                                    | • Private Large Roof Terrace with Barbecue      |
| Girişte Vestiyer Dolabı                                 | • Private Parking Area                          |
| Ebeveyn Yatak Odasında Banyo                            | • Closet Locker at the Entrance                 |
| Yatak Odalarında Aynalı Duvar Dolapları                 | • Bathroom in Master Bedroom                    |
| İki Adet Geniş Balkon                                   | • Fitted Wardrobes with Mirror in all Bedrooms  |
| Çift Cam Alüminyum                                      | • Two Large Balconies                           |
| Lüks Dekoratif Sistemler                                | • Double-Glazed Aluminium                       |
| Yüksek Kalitede Seramik ve Parkeler                     | • Luxury Decorative Systems                     |
| Yüksek Kalitede Aydınlatma Ürünleri                     | • High Quality Ceramic and Parquet Flooring     |
| Yüksek Kalitede Ahşap Doğrama ve Taslagah Ürünleri      | • High Quality Ceramic and Parquet Products     |
| Hidrofor Sistemi  | • High Quality Wood Works and Work-top Products |
| Klima Altyapısı   | • Water Pump System                             |
| Opsiyonel Zeminin İstima Sistemleri                     | • Air Conditioning Infrastructure               |
| Opsiyonel Dekorasyon Paketi                             | • Optional Floor Heating Systems                |
|   | • Optional Decoration Package                   |

EXTERIOR

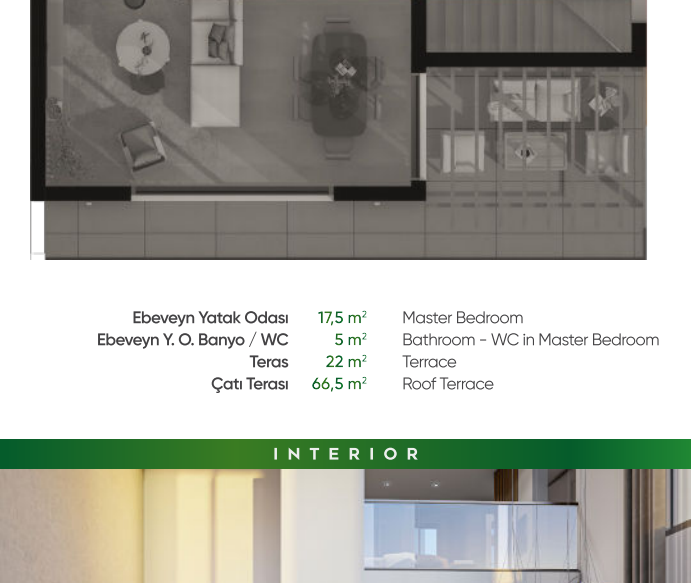
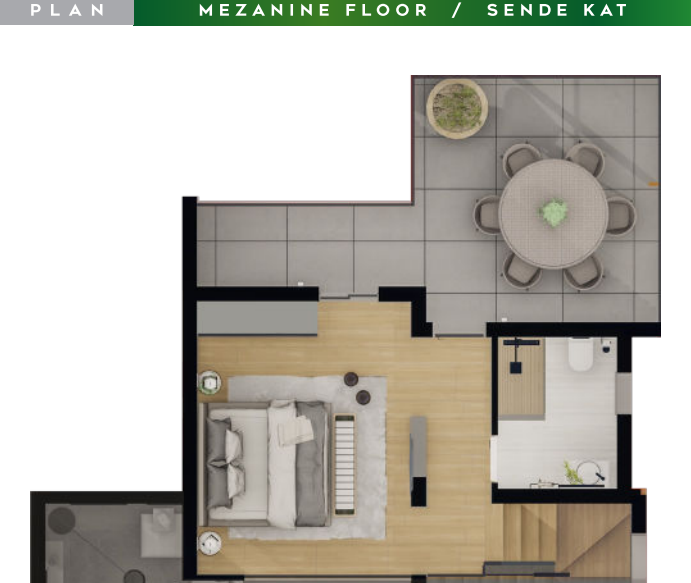
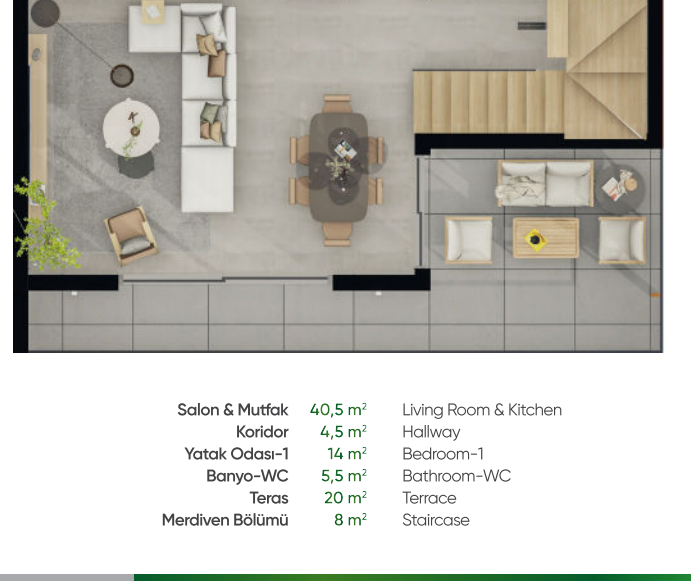

PLAN

FIRST FLOOR / BİRİNCİ KAT



- |                 |                     |                       |
|-----------------|---------------------|-----------------------|
| Salon & Mutfak  | 40,5 m <sup>2</sup> | Living Room & Kitchen |
| Koridor         | 4,5 m <sup>2</sup>  | Hallway               |
| Yatak Odası-1   | 14 m <sup>2</sup>   | Bedroom-1             |
| Banyo-WC        | 5,5 m <sup>2</sup>  | Bathroom-WC           |
| Teras           | 20 m <sup>2</sup>   | Terrace               |
| Merdiven Bölümü | 8 m <sup>2</sup>    | Staircase             |

PLAN

MEZANINE FLOOR / SENDE KAT



- |                         |                     |                                 |
|-------------------------|---------------------|---------------------------------|
| Ebeveyn Yatak Odası     | 17,5 m <sup>2</sup> | Master Bedroom                  |
| Ebeveyn Y.O. Banyo / WC | 5 m <sup>2</sup>    | Bathroom - WC in Master Bedroom |
| Teras                   | 22 m <sup>2</sup>   | Terrace                         |
| Çatı Terası             | 66,5 m <sup>2</sup> | Roof Terrace                    |

INTERIOR



HALKEN İNŞAAT

0 392 444 48 48